

NOTES:
THIS DRAWING IS THE PROPERTY OF O-I AND MUST NOT BE REPRODUCED OR DISCLOSED WITHOUT O-I WRITTEN AUTHORIZATION.

DIMENSIONS EXPRESSED IN mm
ONLY TOLERANCED DIMENSIONS ARE GUARANTEED.

MANUFACTURING MARKINGS SHOWN ARE FOR ILLUSTRATIVE PURPOSES ONLY, ACTUAL MARKINGS ON CONTAINER MAY DIFFER, DEPENDANT ON LOCAL LEGISLATION.

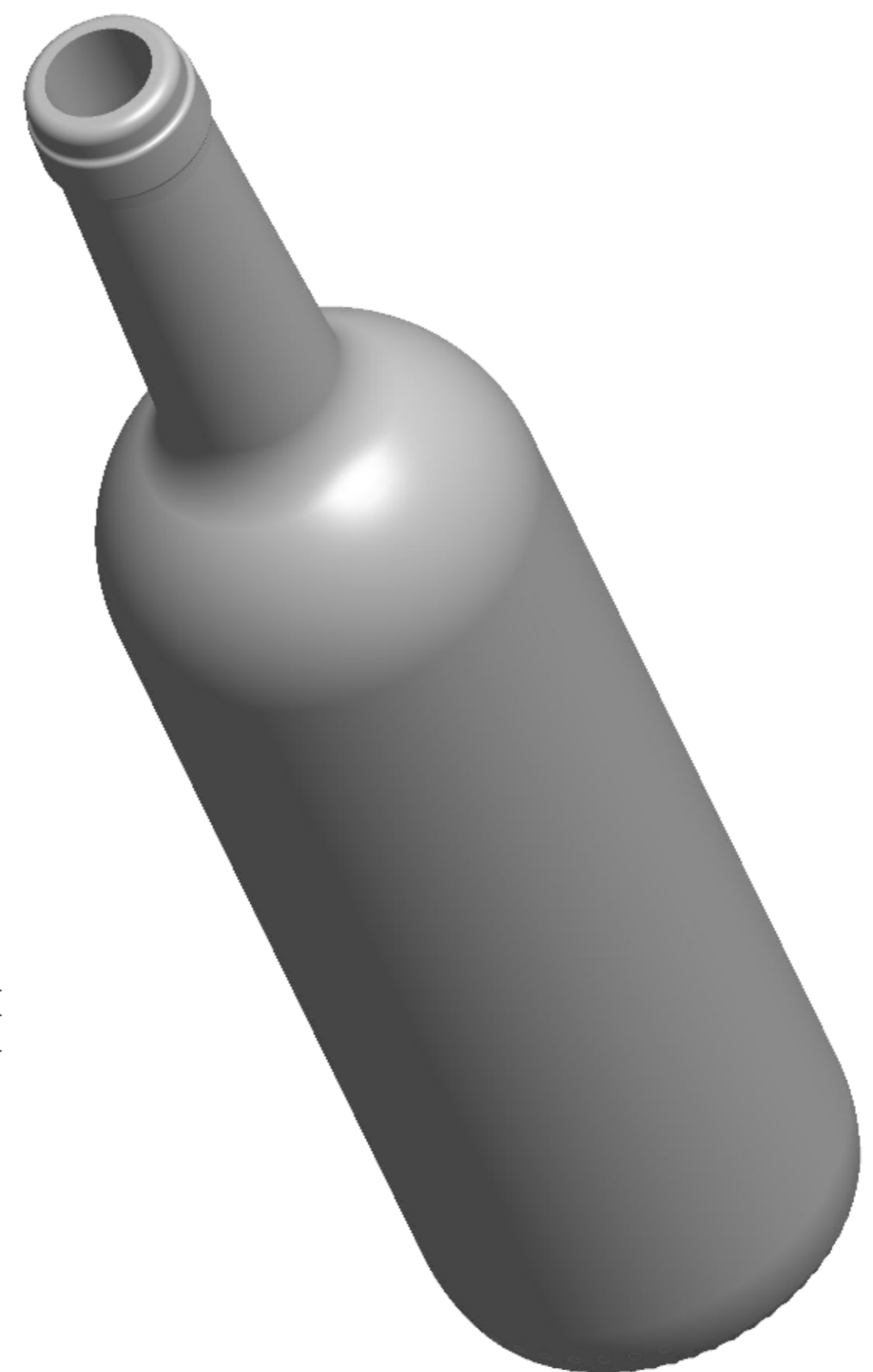

1 = TRADEMARK
2 = CAVITY No.
3 = STIPPLING
THE SHAPE OF STIPPLES IS ONLY AN INDICATION AND THE CONSTRUCTION IS AT THE PRODUCTION PLANT DISCRETION.
4 = CAVITY CODE

SCALE 1:1

TENTATIVE

HEAT TREATMENT 50 °C maxi	CARBONATION XX g CO2/l maxi
VERTICAL LOAD 150 daN maxi	THERMAL SHOCK 42 °C maxi
CATEGORY WINE	TILT ANGLE 15.9°
MAX. VERTICALITY TOLERANCE 3.3 mm	MEASURING CONTAINER YES
FINISH SAP NUMBER 3509	FINISH REF. CETIE GME 50.1 1992
MINIMUM THROUGH BORE 17.5 mm	MAX FILLING TUBE Ø 16 mm

CONTAINER OVERFLOW CAPACITY (BRIMFUL)	
770ml APPROX.	
CONTAINER RATED CAPACITY (FILLPOINT)	
750ml ± 10ml	
CONTAINER WEIGHT	
410g APPROX.	
FINISH DESIGNATION FR_30_GME 50.1_H160_3509	MAX GAS VOLUME
PROCESS RETURNABLE NO	DESIGN REF. IPSO n° 6258

STANDARD
75 CL BD CAR II LG TB

DESIGNER	EBL	DATE	26/10/12
CHECKED		DATE	
DRAWING NUMBER 120223_04		MOULD/SAP NUMBER 000000	

No	DATE	REVISIONS	DESIGN/CHECK