

NOTES:
THIS DRAWING IS THE PROPERTY OF O-I AND MUST NOT BE REPRODUCED OR DISCLOSED WITHOUT O-I WRITTEN AUTHORIZATION.

DIMENSIONS EXPRESSED IN mm
ONLY TOLERANCED DIMENSIONS ARE GUARANTEED.

MANUFACTURING MARKINGS SHOWN ARE FOR ILLUSTRATIVE PURPOSES ONLY, ACTUAL MARKINGS ON CONTAINER MAY DIFFER, DEPENDANT ON LOCAL LEGISLATION.

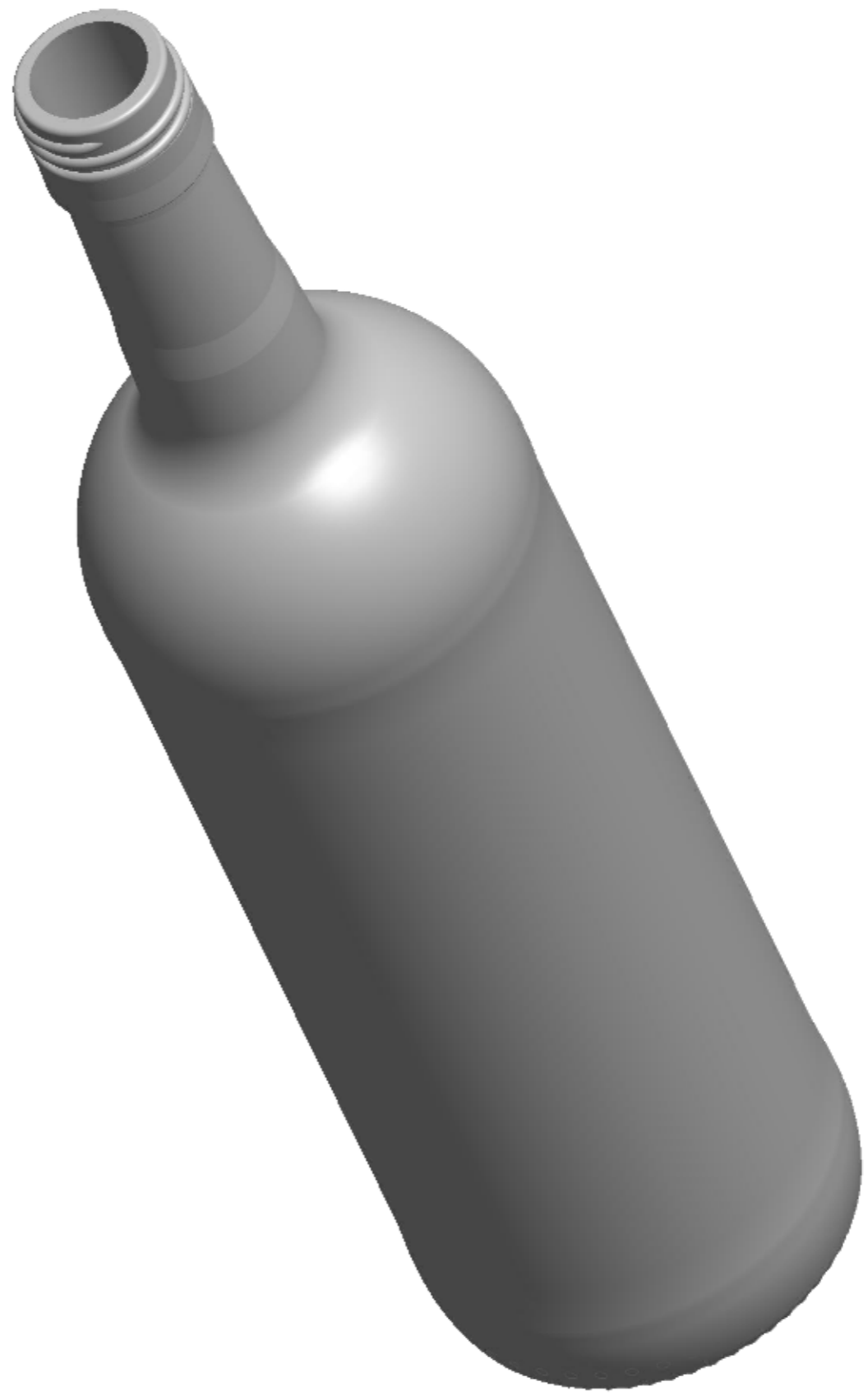

1 = TRADEMARK
2 = CAVITY No.
3 = STIPPLING
THE SHAPE OF STIPPLES IS ONLY AN INDICATION AND THE CONSTRUCTION IS AT THE PRODUCTION PLANT DISCRETION.
4 = CAVITY CODE

SCALE 1:1

TENTATIVE

HEAT TREATMENT 20 °C maxi	CARBONATION 2 g CO2/l maxi
VERTICAL LOAD 180 daN maxi	THERMAL SHOCK 42 °C maxi
CATEGORY WINE	TILT ANGLE 15.86°
MAX. VERTICALITY TOLERANCE 3.3 mm	MEASURING CONTAINER YES
FINISH SAP NUMBER 0860	FINISH REF. CETIE GME 30.13 2007
MINIMUM THROUGH BORE 17.0 mm	MAX FILLING TUBE Ø 15,5mm

CONTAINER OVERFLOW CAPACITY (BRIMFUL)	
765ml APPROX.	
CONTAINER RATED CAPACITY (FILLPOINT)	
750ml ± 10ml	
CONTAINER WEIGHT	
410g APPROX.	
FINISH DESIGNATION EU_30_GME 30.13_H218_0860	MAX GAS VOLUME
PROCESS RETURNABLE NO	DESIGN REF. IPSO n° 6944

STANDARD			
75 CL BD CAR II LG BVS			
DESIGNER	EBL	DATE	31/10/12
CHECKED		DATE	
DRAWING NUMBER 120743		MOULD/SAP NUMBER 00000	

No	DATE	REVISIONS	DESIGN/CHECK